

CW < CCW

ROTATION  
AS SHOWN FOR  
SPECIFICATION  
OF TORQUE  
CW < CCW

CCW = LOW, MEDIUM, HIGH

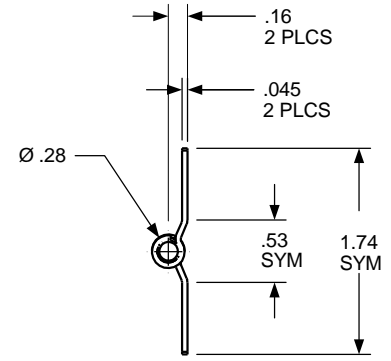
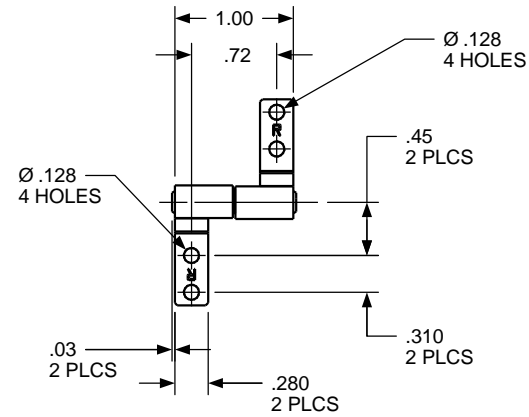
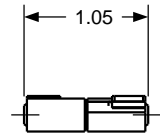

REVISION RECORD				
SYM	DESCRIPTION	BY	DATE	APPD
B	REDRAWN ON NEW FORMAT, NO CHANGES.	RMF	8/15/00	DJC

TORQUE
<u>LOW</u> CCW 2.5 - 4.5 lb. in
<u>MEDIUM</u> CCW 4.5 - 6.0 lb. in
<u>HIGH</u> CCW 6.0 - 7.5 lb. in

USED ON	SOLID	REV	TOLERANCES	DRAWN BY	DATE	<b>ENGLISH</b>		<b>TorqMaster, Inc.</b> Stamford, CT USA	
STANDARD	102	0.0	ENGLISH	RA	5/9/97	MATERIAL		N/A	
NEXT ASSY	NONE		.XX ±.015 in	CHECKED BY	DATE	TITLE		HINGE INTERFACE	
QUANTITY			.XXX ±.005 in	DJC	5/9/97	SIZE		SB 188 SB 102	
PER ASSY, pcs	-		.XXXX ±.0002 in			REV		B	
TOTAL, pcs	-					SCALE		1:1	
THIS INFORMATION IS PROPRIETARY TOTORQMASTER, INC. THE POSSESSOR AGREES TO MAINTAIN IT IN CONFIDENCE . NOT REPRODUCING OR REVEALING IT IN WHOLE OR IN PART.						SHEET		1 OF 1	