

REVISION RECORD				
SYM	DESCRIPTION	BY	DATE	APPD
A	RELEASED PER ERN 04004.	RMF	2/2/04	DJC
B	REVISED PER ECN 06045.	RMF	4/24/06	WB
C	REVISED PER ECN 06090.	RMF	10/9/06	WB

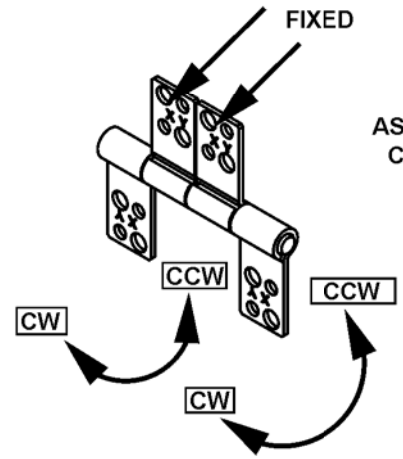

ROTATION AS SHOWN FOR CALLOUT OF TORQUE
 CCW < CW

TORQUE

LOW CW 5.0 - 9.0 lb. in
MEDIUM CW 9.0 - 12.0 lb. in
HIGH CW 12.0 - 15.0 lb. in

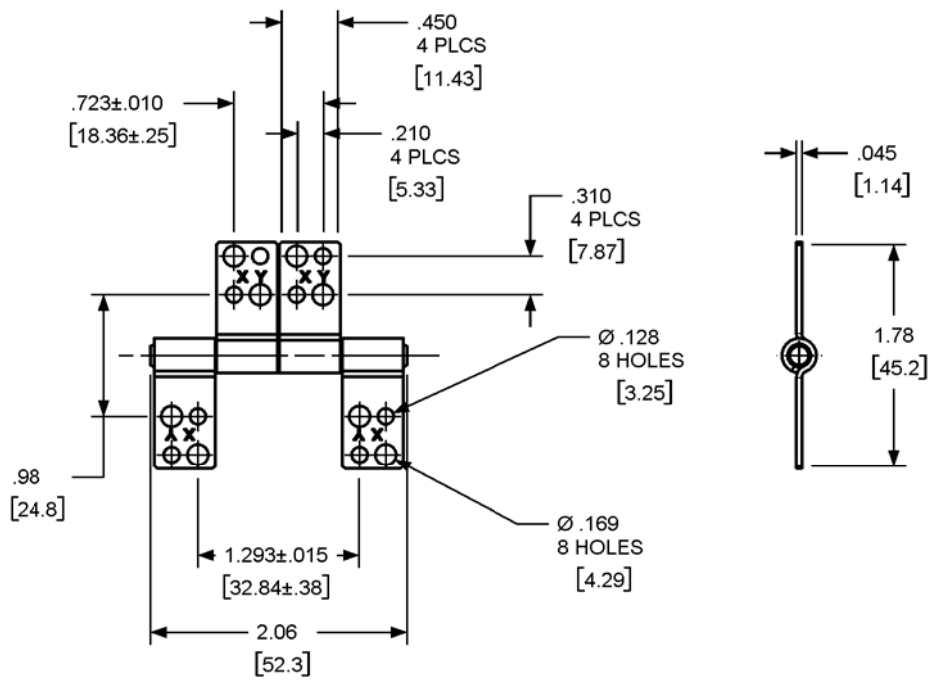

USED ON	SOLID	REV	TOLERANCES		ENGLISH / METRIC		TORQMASTER INTERNATIONAL		200 HARVARD AVE STAMFORD, CT. USA	
STANDARD	231	0.0	ENGLISH	METRIC	DRAWN BY	DATE	MATERIAL	N/A		
NEXT ASSY	N/A		.XX ±.015 IN .XXX ±.005 IN .XXXX ±.0020 IN	.X ±.3 MM .XX ±.13 MM .XXX ±.05 MM	DJC	1/26/04	TITLE	HINGE INTERFACE		
QUANTITY			ANGLES ±0.5° SURFACE 63 μ		CHECKED BY	DATE	SIZE	SB 188 SB 231		REV
PER ASSY, PCS	-				DJC	1/26/04	B			C
TOTAL, PCS	-						SCALE	1:1		SHEET 1 OF 1
THIS INFORMATION IS PROPRIETARY TO TORQMASTER, INTL. THE POSSESSOR AGREES TO MAINTAIN IT IN CONFIDENCE, NOT REPRODUCING OR REVEALING IT IN WHOLE OR IN PART.										