

REVISION RECORD				
SYM	DESCRIPTION	BY	DATE	APPD
B	FRONT VIEW: .13 WAS .08, .76 WAS .80	RA	8/5/19	RA

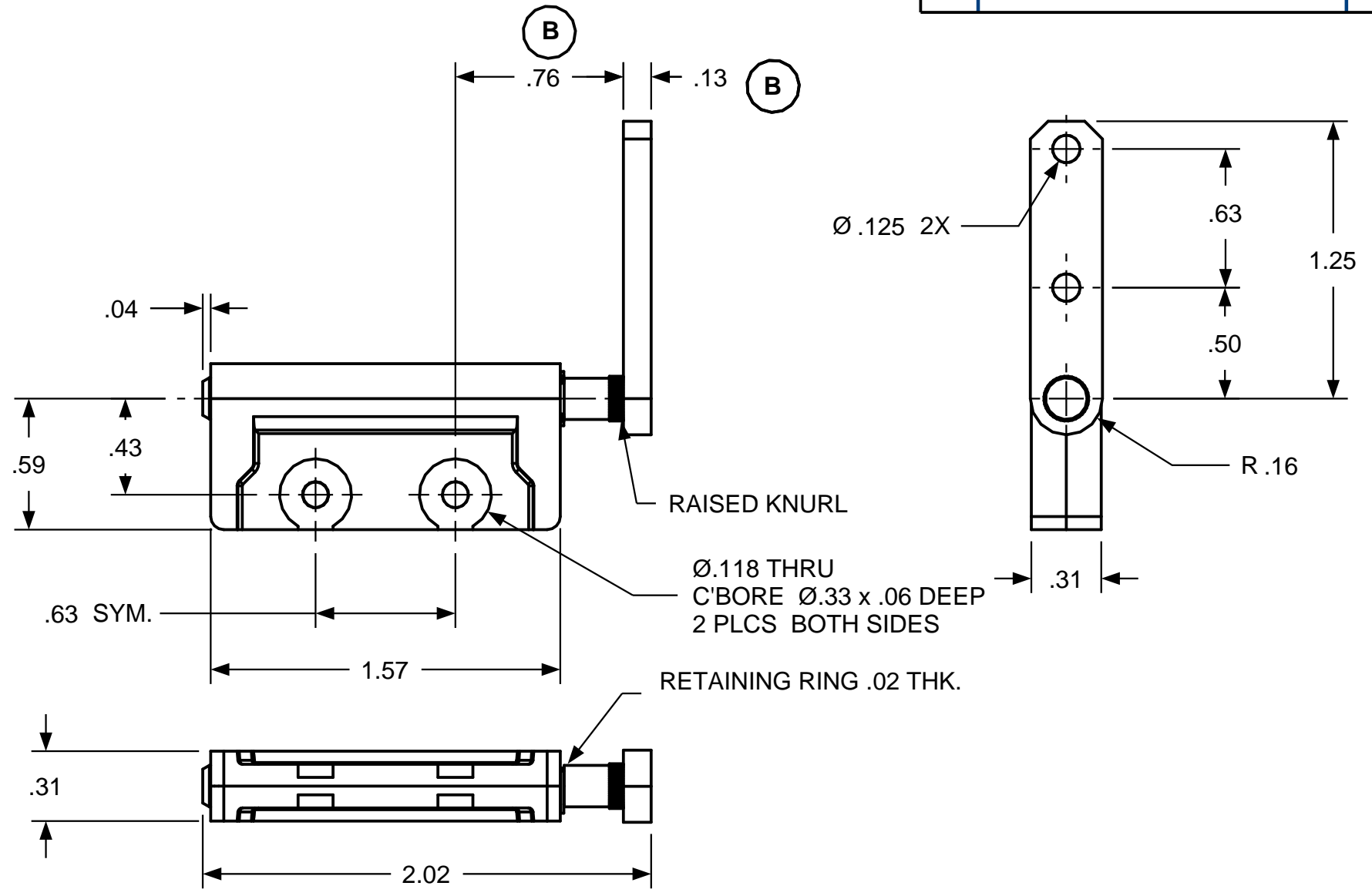
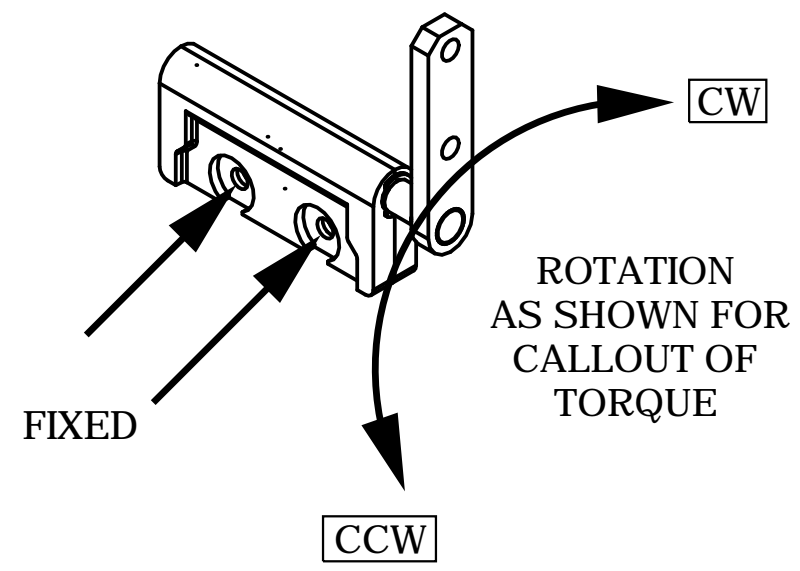

TORQUE		
GEOMETRY	CW TORQUE	CCW TORQUE
ZC 188 SA 101	4	4
ZC 188 SA 101	7	7
ZC 188 SA 101	8	8
ZC 188 SA 101		

CUSTOM TORQUE CONFIGURATIONS AVAILABLE FOR QUOTE:
www.torqmaster.com
 1 - 888 - 41 - HINGE

USED ON	SOLID	REV	TOLERANCES	DRAWN BY	DATE
ZC 188 SA	101	B	ENGLISH	RA	12/21/09
NEXT ASSY	N/A		.XX ±.015 IN .XXX ±.005 IN	CHECKED BY	DATE
QUANTITY					
PER ASSY, PCS		-			
TOTAL, PCS		-			
THIS INFORMATION IS PROPRIETARY TO TORQMASTER, INTL. THE POSSESSOR AGREES TO MAINTAIN IT IN CONFIDENCE, NOT REPRODUCING OR REVEALING IT IN WHOLE OR IN PART.					

ENGLISH		TorqMaster, Inc. Stamford, CT USA	
MATERIAL		N/A	
TITLE		HINGE INTERFACE	
SIZE	ZC 188 SA 101		REV
B			B
SCALE	NTS	SHEET	1 OF 1