

| REVISION RECORD | | | | |
|-----------------|------------------------------------|-----|---------|------|
| SYM | DESCRIPTION | BY | DATE | APPD |
| C | REDRAWN ON NEW FORMAT, NO CHANGES. | RMF | 8/29/00 | DJC |

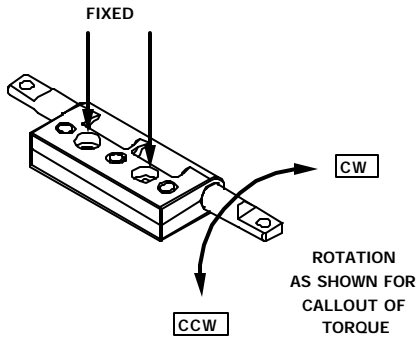

ROTATION AS SHOWN FOR CALLOUT OF TORQUE

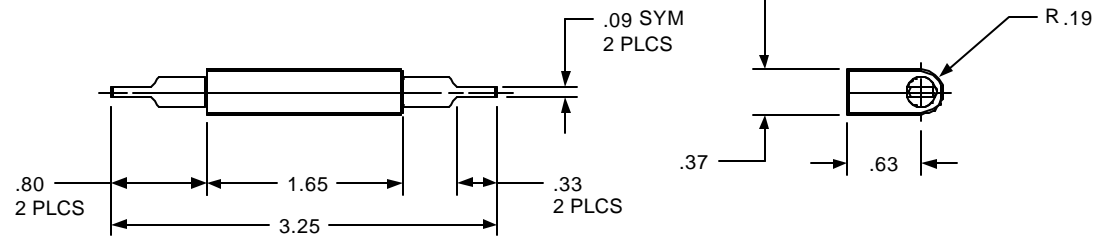
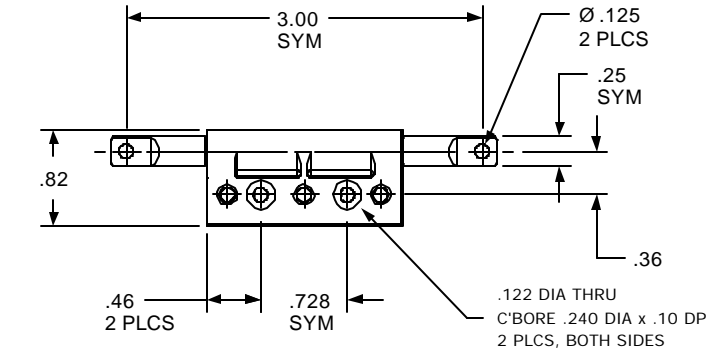

| TORQUE | | |
|---------------|-----------|------------|
| GEOMETRY | CW TORQUE | CCW TORQUE |
| ZC-250-CF-151 | 7 | 7 |
| ZC-250-CF-151 | 14 | 14 |

CUSTOM TORQUE CONFIGURATIONS AVAILABLE FOR QUOTE:
www.torqmaster.com
1-888-41-HINGE

| | | | | | | | | | | | |
|---|-------|-----|-----------------|--------|------------|--------|-----------------|---------------|---------------------------------------|-----|---|
| USED ON | SOLID | REV | TOLERANCES | | DRAWN BY | DATE | ENGLISH | | Torq Master, Inc. Stamford, CT USA | | |
| STANDARD | 151 | 0.0 | ENGLISH | METRIC | RA | 5/9/97 | MATERIAL | | N/A | | |
| NEXT ASSY | NONE | | .XX ±.015 in | | CHECKED BY | DATE | TITLE | | | | |
| QUANTITY | | | .XXX ±.005 in | | DJC | 5/9/97 | HINGE INTERFACE | | | | |
| PER ASSY, pcs | - | | .XXXX ±.0002 in | | | | SIZE | ZC 250 CF 151 | | REV | |
| TOTAL, pcs | - | | | | | | B | | | C | |
| THIS INFORMATION IS PROPRIETARY TO TORQMASTER, INC. THE POSSESSOR AGREES TO MAINTAIN IT IN CONFIDENCE. NOT REPRODUCING OR REVEALING IT IN WHOLE OR IN PART. | | | | | | SCALE | 1:1 | SHEET | 1 | OF | 1 |